

ROUTE 145, WINTHROP ROAD
CHESTER, CONNECTICUT 06412-0684
TELEPHONE: (860) 526-9504
FAX: (860) 526-4078

For Models DMP1S
DMP2S
DMP3S

Installation...

1. Determine mounting style (windshield or dashboard).
2. For windshield mounting, apply the supplied suction cups to the universal mounting bracket. For dashboard mounting use the velcro strips (See Figs.1 & 2).
3. To adjust the DashMiser™, loosen the adjustment nuts, position DashMiser™ for optimum visibility and re-tighten the adjustment nuts (Fig.2). Your DashMiser™ should be adjusted so that it's beam is parallel with the road at drivers-eye level. This ensures visibility by other vehicles on the road (See Fig.3).
4. Plug power cord into your vehicle's cigarette lighter socket to activate the DashMiser™. If you are installing the DMP3S, refer to Fig.4 when wiring the center take-down lamp.

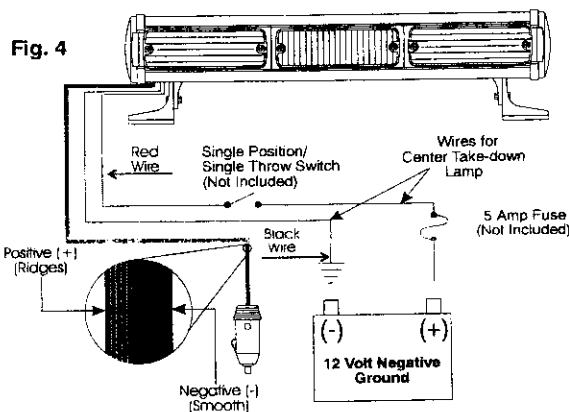
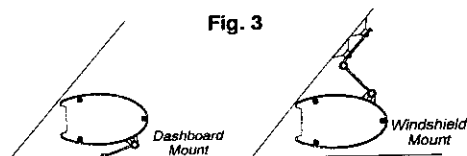
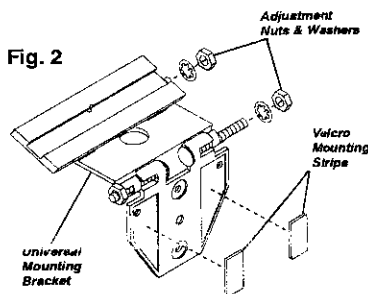
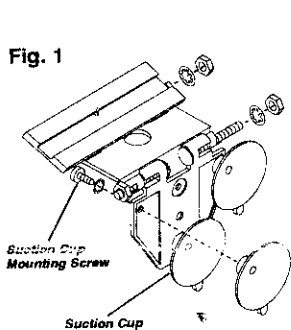

Options...

Below are the options that are available for the DashMiser™ Plus Strobe. Please be sure to note the model number of the desired option when ordering.

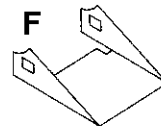
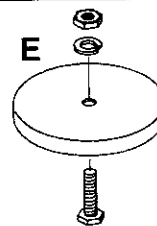
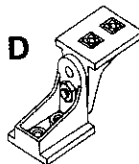
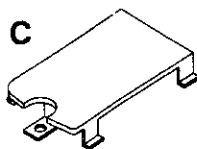
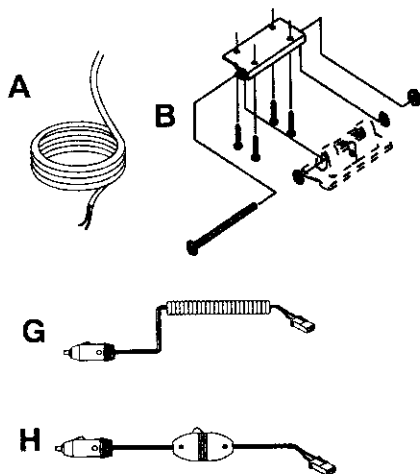

Description

- A - 15 FOOT POWER CORD (DM3H & DM3S ONLY)
- B - MOUNTING BRACKET FOR CROWN VICTORIA
- C - SPLIT LENS COLOR FILTER
- D - SWIVEL FOOT MOUNT
- E - MAGNETIC MOUNT KIT
- F - SIDE GLARE SHIELD KIT
- G - COILED CIGAR POWER CORD
- H - CIGAR POWER CORD WITH REMOTE SWITCH

Not Shown- MOUNTING BRACKET FOR FORD EXPLORER
Not Shown- MOUNTING BRACKET FOR CAPRICE CLASIC

* = Insert Letter for desired color - **A** Amber, **B** Blue, **G** Green, **R** Red

** = Insert number for model being ordered - 1 = DMP1SL, 2 = DMP2SL

Model Number

EXT15
DMBCV94
DMPIL*
DMPED
DMMM
DMPWH**
DMCC
DMPGPSW
DMBEXP94
DMBCAP94

Let's Be Careful Out There...

Nobody knows the importance of safety better than those of you who are Emergency Respondents. Everyday, you are witness to the consequences of careless behavior. And everyday, the lesson is driven home once again; if you follow the rules, you'll be all right.

Now what could this possibly have to do with installing your new **Whelen DashMiser™**? Simple. The same concept also holds true when installing ANY additional equipment in or on your vehicle. Our safety guidelines are not arbitrarily thrown in just to please us. They serve an important purpose. And, believe it or not, may just save your life. The decision whether or not to follow these guides is yours to make, just as it's your decision whether or not to wear seat belts. You know the results of making the wrong choice in that instance.

So do us both a favor. Take the time to read the warnings we have provided below. Yes, it will add a few minutes to the installation time, but if by following our recommendations you save yourself or your passengers the risk of potential injury, wouldn't you consider those minutes time well spent?



WARNING! AIR BAG SENSITIVE PRODUCT!

Do not install this product and/or route wires or cord in deployment path of an air bag. Equipment mounted or located in air bag deployment area will damage or reduce effectiveness of air bag, or become a projectile that could cause serious personal injury or death. To determine air bag deployment area, refer to vehicle manufacturer's manual or instructions.



CAUTION! MAGNETIC MOUNT USAGE!

The use of magnetic mounted warning beacons on the roof of a vehicle in motion is at the sole discretion and risk of the user. Whelen Engineering makes no warranties or guarantees of equipment used in this way.

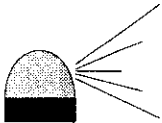

CAUTION! INTENSE LIGHT!

This product produces an intense light (flashing or otherwise) during the course of it's normal operation. Do not position this product in such a way that this light will be visible to the vehicle operator. Exposure to light of such sudden intensity may cause a momentary lack of visual acuity. Under no circumstances should anyone look directly at the light source when product is connected to a power source.



CAUTION! WATER SENSITIVE!

Do not attempt to wash this or any other electrical device while it is connected to it's power source. Exposure to any liquid while product is connected to power source may result in an electrical short circuit within the product and will cause permanent damage to the product and possible injury to the user.



CAUTION! ELECTRICAL FUSING!

All customer supplied wires that connect to the positive terminal of the battery, must be sized to supply at least 125% of the maximum operating current and must be fused "AT THE BATTERY" to carry that load.



WARNING! SHOCK HAZZARD!

Do not attempt to touch any interior components until at least 5 (five) minutes have elapsed since device has been disconnected from it's power supply. This will prevent accidental electrical discharge from occurring that could cause a High-Voltage shock

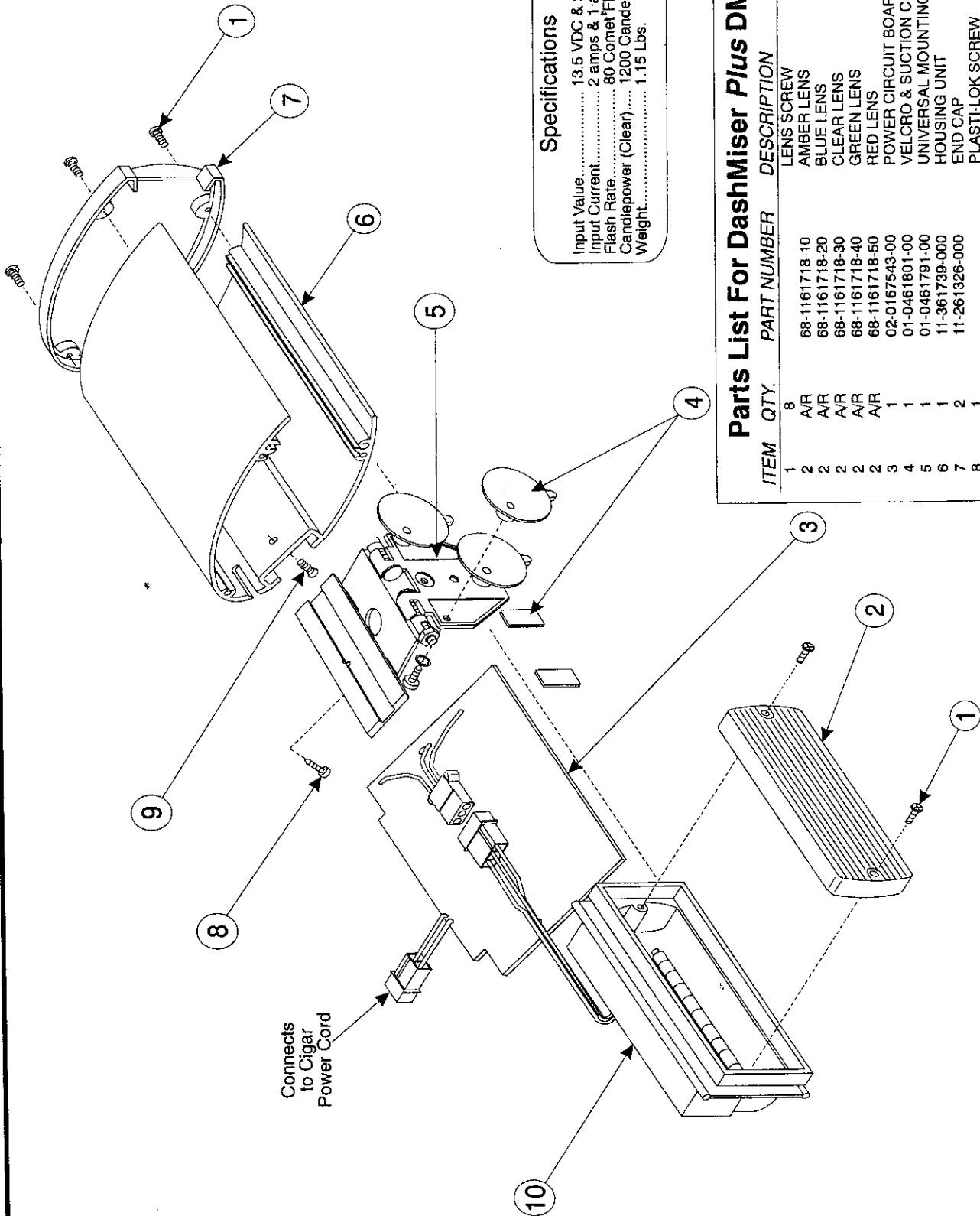

Specifications

Input Value..... 13.5 VDC & 26.5 VDC \pm 20%
 Input Current..... 2 amps & 1 amp (typ)
 Flash Rate..... 80 Comet/Flash Per Minute
 Candlepower (Clear)..... 1200 Candela
 Weight..... 1.15 Lbs.

Parts List For DashMiser Plus DMP1S

ITEM	QTY.	PART NUMBER	DESCRIPTION
1	8		LENS SCREW
2	A/R	68-1161718-10	AMBER LENS
2	A/R	68-1161718-20	BLUE LENS
2	A/R	68-1161718-30	CLEAR LENS
2	A/R	68-1161718-40	GREEN LENS
2	A/R	68-1161718-50	RED LENS
3	1	02-0167543-00	POWER CIRCUIT BOARD (PCB)
4	1	01-0461801-00	VELCRO & SUCTION CUP KIT
5	1	01-0461791-00	UNIVERSAL MOUNTING KIT
6	1	11-361739-000	HOUSING UNIT
7	2	11-261326-000	END CAP
8	1		PLASTI-LOK SCREW
9	1		PCB RETAINING SCREW
10	1	52DMTUBE	REFLECTOR/STROBE LIGHT ASSEMBLY

Specifications

Input Value..... 13.5 VDC & 26.5 VDC \pm 20%
 Input Current..... 3.5 amps & 1.75 amps
 Flash Rate..... 130 Comat' Flash Per Minute
 Candlepower (Clear)..... 1200 Candela
 Weight..... 2.25 Lbs.

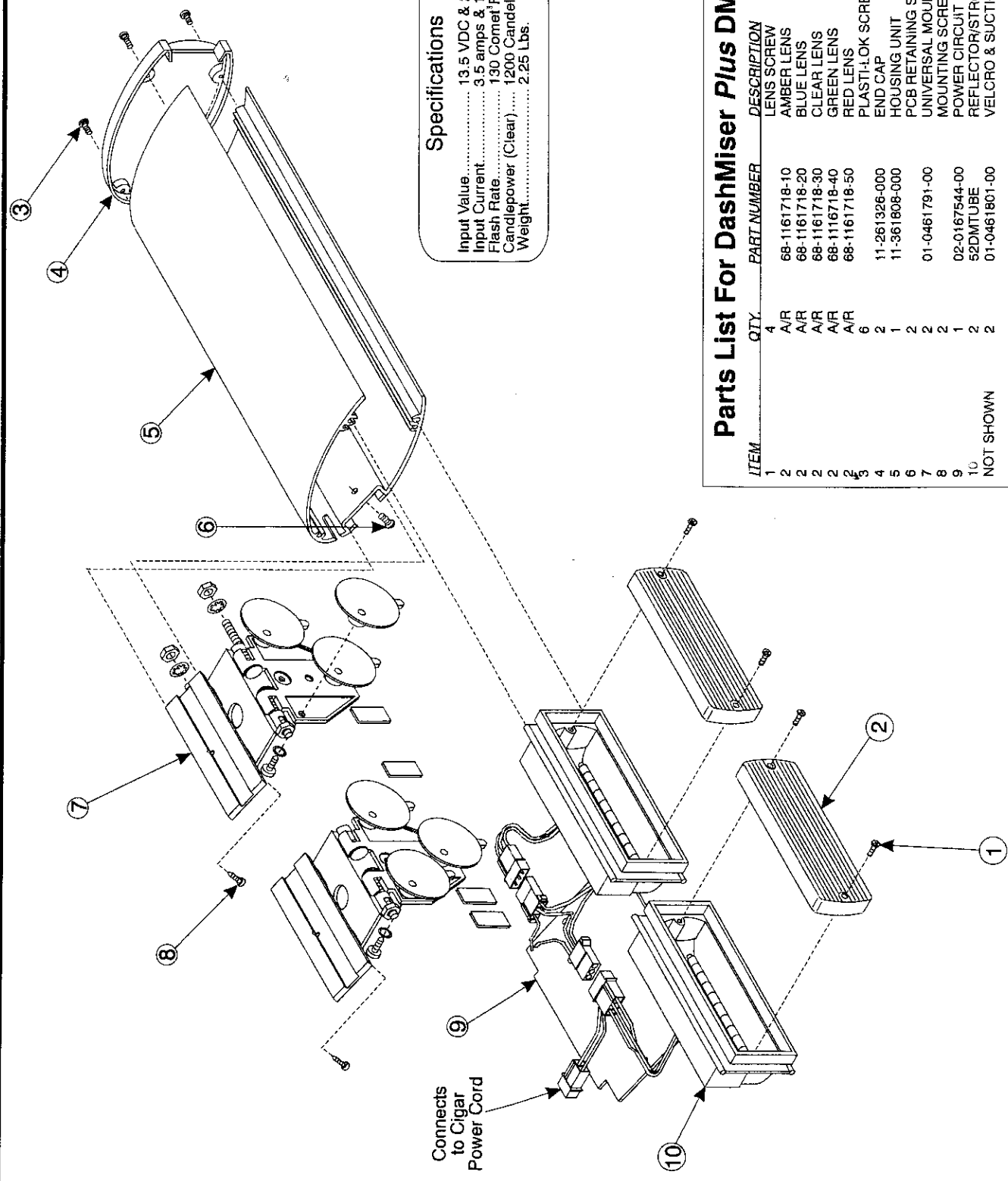

Parts List For DashMiser Plus DMP2S

ITEM	QTY.	PART NUMBER	DESCRIPTION
1	4		LENS SCREW
2	A/R	68-1161718-10	AMBER LENS
2	A/R	68-1161718-20	BLUE LENS
2	A/R	68-1161718-30	CLEAR LENS
2	A/R	68-1161718-40	GREEN LENS
2	A/R	68-1161718-50	RED LENS
3	6		PLASTI-LOK SCREW
4	2	11-261326-000	HOUSING UNIT
5	1	11-361808-000	PCB RETAINING SCREW
6	2		UNIVERSAL MOUNTING KIT
7	2	01-0461791-00	MOUNTING SCREW KIT
8	2		POWER CIRCUIT BOARD (PCB)
9	1	02-0167544-00	REFLECTOR/STROBE LIGHT ASSEMBLY
10	2	S2DMTUBE	
	2	01-0461801-00	VELCRO & SUCTION CUP KIT
			NOT SHOWN

Parts List For DashMiser Plus DMP3S

ITEM	QTY.	PART NUMBER	DESCRIPTION
1	6		LENS SCREW
2	A/R	68-1161718-10	AMBER LENS (STROBE LAMP)
2	A/R	68-1161718-20	BLUE LENS (STROBE LAMP)
2	A/R	68-1161718-30	CLEAR LENS (STROBE LAMP)
2	A/R	68-1161718-40	GREEN LENS (STROBE LAMP)
2	A/R	68-1161718-50	RED LENS (STROBE LAMP)
3	1	H27T12	HALOGEN LIGHT ASSEMBLY
4	1	68-5181384-01	HALOGEN REFLECTOR
5	1	46-07458603-00	STROBE EXTENSION COUPLING
6	8		PLASTI-LOK SCREW
7	2	11-261326-000	END CAP
8	1	11-361816-000	HOUSING UNIT
9	2	01-0461791-00	UNIVERSAL MOUNTING KIT
10	2		MOUNTING KIT SCREW
11	2		PCB RETAINING SCREW
12	1	02-0167544-00	POWER CIRCUIT BOARD(PCB)
13	2	52DMTUBE	REFLECTOR/STROBE ASSEMBLY
14	NOT SHOWN	01-0461801-00	VELCRO & SUCTION CUP KIT
14	A/R	68-1161313-10	AMBER LENS (HALOGEN LAMP)
14	A/R	68-1161313-20	BLUE LENS (HALOGEN LAMP)
14	A/R	68-1161313-30	CLEAR LENS (HALOGEN LAMP)
14	A/R	68-1161313-40	GREEN LENS (HALOGEN LAMP)
14	A/R	68-1161313-50	RED LENS (HALOGEN LAMP)

Specifications

Input Voltage..... 13.5 VDC & 26.5 VDC \pm 20%
 Input Current..... 3.5 amps & 1.75 amps
 Flash Rate..... 130 Comet Flash Per Minute
 Candlepower (Clear)..... 1200 Candela
 Weight..... 2.25 Lbs.

